



Instant established the Agile CRE ThinkTank (ACT) in March 2020, bringing together global industry leaders to crowd-source insights, share experiences and explore and develop best practices around real estate in the face of the global pandemic.

Since 2020 we have conducted qualitative research via in-depth interviews with over 75 senior Real Estate, Facilities and HR professionals across the globe.

This summary outlines our findings from Round 2 interviews, which concluded in May 2021.

To learn more or participate in the ACT, get in touch:
contact.us@theinstantgroup.com

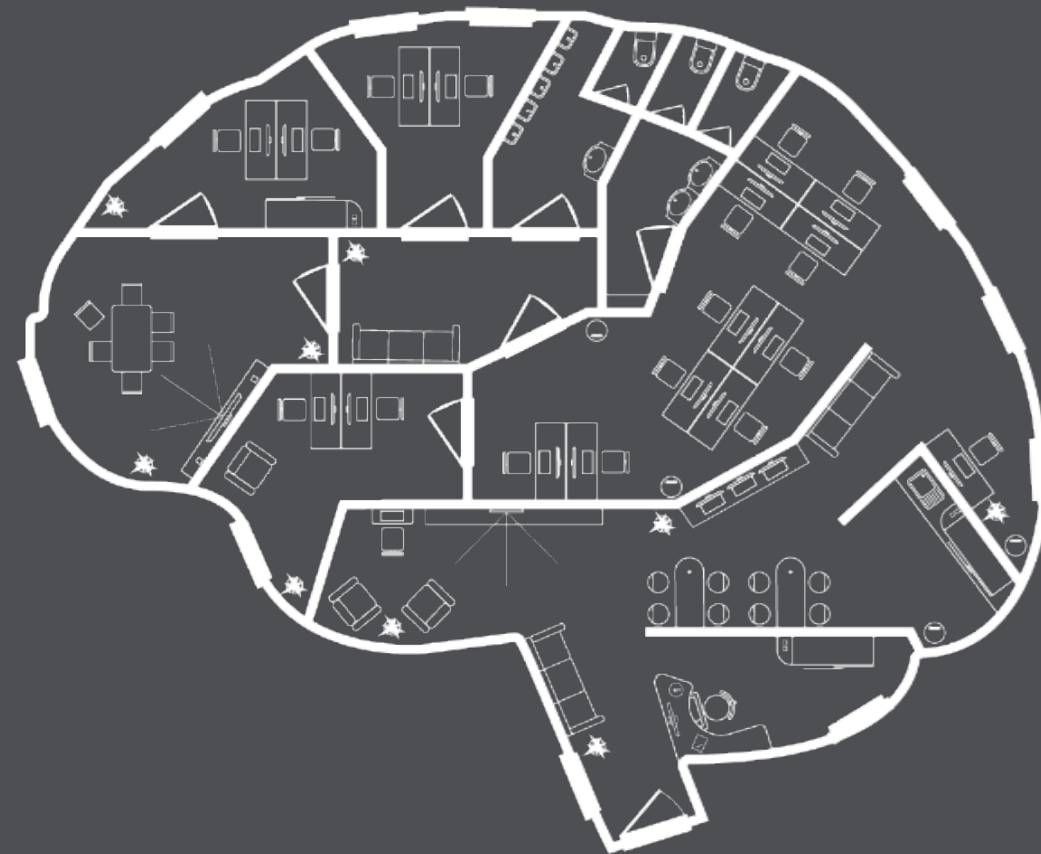

Instant
RETHINKING WORKSPACE



Test and Learn: Return to Office

As businesses start to return to the office, Heads of CRE are looking at technology to drive collaboration and enable choice across their portfolios. They want to consolidate their real estate but also understand that the absence of the physical office has compromised staff energy levels and ultimately wellbeing. [Read more in our latest blog](#)

Planning the Return to Office

Only **7%** of businesses have a concrete return-to-office plan

Future Portfolio Strategy

The majority of businesses are **uncertain** about the future of their portfolios

Power to the People

42% said **improving work location choice** for employees was a priority

Workspace Design

42% of respondents placed collaboration as the **#1 priority** for workspace design

Company Culture

69% of respondents viewed company culture as the **most critical factor** in future decision making

Technology & Digital

At **60%**, **space utilisation tech** came out as the **#1 tool** currently being looked at